

!tipo_vivienda : Radhus

Beläget : Pilar De La Horadada

Sovrum : 2

Badrum : 2

Bo yta : 69 m²

Tomtyta : 139 m²

✓ Förinstallation

✓ Takterrass



Plot nº13



PB / GROUND FL

VILLA Nº 13 PLOT 13 199,80 m2

SUP. CONSTR. VIV. P.B.69,30 m2
SUP. CONSTR. Porch (50%)3,00 m2
SUP. CONSTR. TOTAL74,30 m2
SUP. UTIL. SOLARIUM43,51 m2
SUP. TOTAL VIV137,81 m2

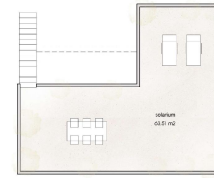

P1 / FIRST FL

Master Plan

