



**!tipo\_vivienda :** Radhus

**Beläget :** Pilar De La Horadada

**Sovrum :** 3

**Badrum :** 2

**Bo yta :** 82 m<sup>2</sup>

**Tomtyta :** 144 m<sup>2</sup>

✓ Förinstallation

✓ Takterrass



Plot nº2



**VILLA Nº 2**

SUP. CONSTR. VIV P.B.	82,07 m <sup>2</sup>
SUP. CONSTR. Porch (club)	2,38 m <sup>2</sup>
SUP. CONSTR.TOTAL	84,45 m <sup>2</sup>
SUP. ÚTIL SOLARUM	75,95 m <sup>2</sup>
SUP. TOTAL VIV	160,40 m <sup>2</sup>
<b>PLOT 144,55 m<sup>2</sup></b>	

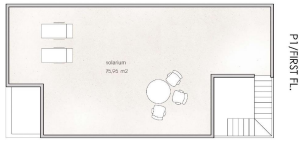

Master Plan

